



## Software Update

TSB #	SUBJECT	DATE
SRB-R58.0	Tool Software Update 58.0	October 5, 2018
S/W VERSION[S]	TOOL[S] AFFECTED	
58.0	Tech400SD, Tech500, Tech300Pro, Tech300ProC and Tech400Pro. See chart for specific improvements to the respective tools.	

### OVERVIEW

Feature	Exclusive	Benefit	400SD	500	300PRO	300PROC	400PRO
Updated Interface & [HMI] Menu Flow	★	Faster, easier to use, and quickly identify the coverage on a Make-Model-Year	✓	✓	✓	✓	✓
VINdicate®	★	Automatically detect the VIN and decode the Make, Model, and Year through the OBDII connection.		✓		✓	✓
Dual Rear Wheel (Dually) Support for GM, Ford, and Ram		Tool will display the proper wheel configurations based on the MMY	✓	✓	✓	✓	✓
Process Speed		Tool functions have been reviewed for efficiency and processes shortened and made more intuitive where possible.	✓	✓	✓	✓	✓
Improved Sensor Programming		The update process makes for clearer instructions for programming both 1 sensor, and a complete set.	✓	✓	✓	✓	✓
Improved Handling of the Spare Tire TPMS	★	When using VINdicate®, the tool will automatically configure for the TPMS sensor in the spare tire.	✓	✓		✓	✓
Improved Aftermarket Sensor Programming		Improved navigation allows for a more simplified aftermarket sensor programming process.	✓	✓	✓	✓	✓
Support for Multiple Relearn types		Vehicles with both OBD and Stationary/Auto Learn will show both types of relearns	✓	✓	✓	✓	✓
Automatic Data Save	★	Inspection and service data saved at key points in the inspection and service process. Makes data retrieval more complete and accurate.	✓	✓	✓	✓	✓
Resume Service		Because of Automatic Data Save, you now have the ability to pick back up on a vehicle right where you left off	✓	✓	✓	✓	✓
Service History		View sensor and vehicle data on previous vehicles right on the tool screen	✓	✓	✓	✓	✓
Individual model year instead of "date ranges."	★	Improving the manual look up process, the tool has split out each Model Year independently and also show the 10 <sup>th</sup> digit of the VIN for reference	✓	✓	✓	✓	✓
Auto Sensor ID	★	Wirelessly determine what sensor is fitted in the Wheel/Tire [only support EZ-sensor® and QWIK® sensor at this time]		✓	✓	✓	✓
Bluetooth Pairing		Added on tools screen the ability to verify what the tool is paired to as well as split out the pairing process for TPMS Desktop, other BT device, and Bartec		✓	✓	✓	✓

©2018, Bartec USA, LLC

Bartec USA Technical Support: [866]407-8767

Bartec makes commercially reasonable efforts to provide accurate and complete data in connection with our tools and our website, but the volume of data compiled and the variety of sources from which the data comes makes it impossible to warrant full accuracy or completeness of any kind. AS A RESULT, BARTEC DOES NOT WARRANT, AND SPECIFICALLY DISCLAIMS ANY WARRANTY, THAT OUR TOOLS, WEBSITE, AND/OR THE CONTENT CONTAINED THEREIN IS ACCURATE OR COMPLETE.





## Software Update

		Printer					
Recommended Inflation Pressure [Placard] Coverage		Added Placard Adjustment coverage for 66 selections including Chevrolet, Ram, Jeep, and GMC.		✓			✓
JohnDow Dynamic DVT® support added		Updated coverage for the DVT® TPMS for Ford Corp. and Audi/VW coverage	✓	✓	✓	✓	✓
Schrader EZ-sensor® support added		Updated coverage for the Schrader EZ-sensor® for new programs	✓	✓	✓	✓	✓
Huf IntelliSens® support added		Update coverage for the Huf IntelliSens® sensor for new programs	✓	✓	✓	✓	✓
NEW OE Toyota Pacific sensor support		Support for the new CCTB sensors from Pacific for the earlier Toyota parts	✓	✓	✓	✓	✓
Revolution Supply PDQ TPMS support added		Added coverage for programming the PDQ TPMS sensors	✓	✓	✓	✓	✓
Coverage Update: Hyundai Equus COMMS		OBD relearn and diagnostic support for the Hyundai Equus now possible.	✓	✓		✓	✓
Coverage Update: Ford GT sensor		Added support for the Ford GT TPMS Sensor	✓	✓	✓	✓	✓
Removed support for CUB brand Aftermarket TPMS Sensors		Dorman Multi-Fit, ITM Uni-sensor, and Group 31 SMART Sensor are no longer supported for sensor programming.	✓	✓	✓	✓	✓

### Updated Menu Flow

This latest release features an updated Menu Flow to the tool. A slight change to the order in which things are done means a more efficient and logical way to complete TPMS service. The tool easier to set up and faster when diagnosing and repairing vehicles because you now connect to the vehicle FIRST. After vehicle section, the following is the complete list of service options available. What is actually supported will depend on the specific make, model and year selected.

- OBD Diagnostics
- Test Sensors
- Relearn – OBD
- Relearn – Stationary
- Relearn – Drive
- Placard Pressure Change
- Program Sensors



## Software Update

### VINdicate®

As part of this new way to interact with the Bartec TPMS, there is now a choice when setting up the tool for use. The traditional manual look up of make-model-year, or the automated method known as VINdicate®. This revolutionary process uses the data collected from the OBD. Once connected, the tool retrieves the VIN, decodes it, and the retrieves the Diagnostic Trouble Codes [DTC's].



### Dual Rear Wheel (Dually) Support for GM, Ford, and Ram

Support has been added for GM, Ford and Ram trucks with Dual Rear Wheels that are fitted with OE TPMS Systems. The pressure values for the 4 wheels on the rear axle are displayed as shown in the figure to the right.



### Process Speed

Time is money! This update features streamlined sensor activation and decoding along with optimized menu navigation, optimized for faster, more efficient use of the tool.

### Improved handling the spare tire TPMS

With release 58 installed, the tool will now set-up the number of wheels (TPMS in the Spare) based on the read out from the vehicle's OBD. This will help eliminate the guessing if a 5 wheel is needed or not. If the technician skips OBD Diagnostics, the Relearn process will still verify the correct number of wheels were read, and if a 5<sup>th</sup> is required, prompt the technician to read the spare.



*Effected vehicle manufactures: Toyota/Lexus, Chrysler/Jeep/Dodge*

### Improved Aftermarket Sensor Programming

The update process makes for clearer instructions for programming both 1 sensor, and a complete set. The process has been optimized along with made consistent from Create to Copy.

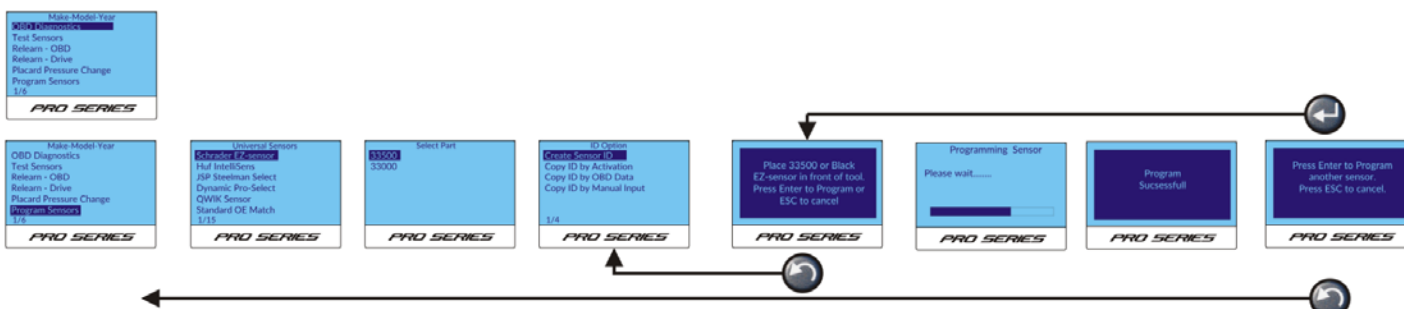



## Software Update

### Support for Multiple Relearns

For some time your Bartec tool has supported “Bonus” OBD relearn coverage for vehicles like Chrysler, GM, and Ford. Bonus OBD coverage is defined as the OBD Relearn solution for either a STATIONARY or AUTO LEARN vehicle. With release 58 installed, the technician can clearly identify these “multiple relearn” vehicles, and chose which option suits best.



### Automatic Data Save

Your tool once updated to release 58 will “auto save” data. Additionally that data is saved following each function completed, allowing a full inspection and service report to be completed.



### Resume TPMS Service

With this new feature technicians can stop the service of a vehicle at any point and pick back up where they left off, building a complete inspection and service report for that vehicle.

### Service history

Quickly view the data from previous vehicles right on the tool.

### Individual Model Year Look Up

An exclusive feature to a TPMS tool, Bartec has split out each year individually and added the additional information of the 10<sup>th</sup> digit of the VIN right on the tool screen. This will allow for faster and more accurate tool set-up when selecting the “Select by MMY” method.



### Auto Sensor ID

Allows Technician to wirelessly identify the aftermarket sensor brand mounted in a wheel and tire. For R58, this feature will only support the Schrader EZ-sensor® 33500 and the SMP QWIK® sensor QS104 and QS105.

This new feature is located in the Test Sensors under Sensor Test Toolkit.

Select the function and aim the tool at the sensor the same as you would to activate the sensor during a Test or Relearn.

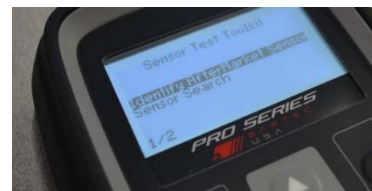



## Software Update

### Bluetooth Pairing Improvements

R58 improves the pairing process and on tool status information by breaking out the devices you are pairing to separate as well as allowing you to verify what the tool is paired to currently.

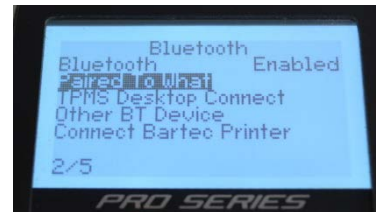

### Recommended Inflation Pressure [Placard] Coverage

Added coverage for Chevrolet, Ram, Jeep, and GMC for Placard Pressure Change.

Make	Model	Make	Model	Make	Model
Cadillac	Escalade	Chevrolet	Suburban	GMC	Savana
Chevrolet	Equinox	Chevrolet	Tahoe	GMC	Terrain
Chevrolet	Express	Chevrolet	Traverse	GMC	Yukon All
Chevrolet	Impala	Dodge	RAM 1500	Jeep	Cherokee
Chevrolet	Orlando	Dodge	RAM 2500	Jeep	Grand Cherokee
Chevrolet	Silverado 1500	Dodge	RAM 3500 SRW	Jeep	Wrangler
Chevrolet	Silverado 2500	GMC	Acadia		
Chevrolet	Silverado 3500	GMC	Canyon		

### JohnDow Dynamic DVT® support added

R58 increases the coverage for JohnDow's DVT TPMS sensor program.

For more information on this sensor program, please visit [www.johndow.com](http://www.johndow.com)

### Schrader EZ-sensor® support added

R58 increases the coverage for the Schrader EZ-sensor program.

### Huf IntelliSens® support added

R58 increases the coverage for the Huf IntelliSens program.

### NEW OE Toyota Pacific sensor support

Pacific Manufacturing has introduced a new OE level replacement sensor. The new CCTB sensor will be replacing the B1-Type sensor. This new sensor will use the same "body" as newer sensors from Pacific, but is electronically compatible with the older applications. Use of these sensors with your tool will be seamless. For more information, please contact Pacific Manufacturing or reference their TSB 1024701MB.

### Revolution Supply PDQ TPMS support added

R58 adds support for the Revolution Supply PDQ TPMS sensor program. For more information on this sensor program, please visit [www.pdqtpms.com](http://www.pdqtpms.com)

### Coverage Update: Hyundai Equus COMMS

Added OBD support for the Hyundai Equus.



## Software Update

### Coverage Update: Ford GT sensor

Added coverage for the Ford GT sensor for 2018 and 2019 to support the Test Sensor and Stationary Relearn for this vehicle.

### Removed support for CUB brand Aftermarket TPMS Sensors

Effective R58.0, the Dorman MULTI-Fit, ITEM UNI-sensor, and Group 31 SMART sensor are no longer supported for sensor programming. These aftermarket sensors can still be used with your Bartec tools, but will need to be programmed using the devise supplied by the sensor manufacture first.