

## TREAD-RITE® Quick Start Guide

Congratulations on purchasing North America's newest Tread Measurement Tool!  
Please take time and review this Quick Start Guide, and the digital User Guide found on [www.bartecusa.com](http://www.bartecusa.com). The following detailed information will be useful when calling Bartec about your tool. Keep this Quick Start Guide with the tool for future reference.

**BARTEC TECHNICAL SUPPORT:**  
**TOLL FREE: [866]407-8767 E-Mail: [help@bartecusa.com](mailto:help@bartecusa.com)**

### GETTING STARTED USING YOUR TREAD-RITE:

#### Getting Started:

- Fitting Batteries
- Power on
- Connectivity
- Completing a Vehicle Inspection:  
Bartec TPMS Tool
- Completing a Tread Inspection:  
Bartec Tool
- Configurable Settings
- Calibration
- Correct use of the Tread-Rite®

#### Tool Layout:



#### Fitting Batteries:

Remove the end cap, insert the AAA batteries & refit the end cap.

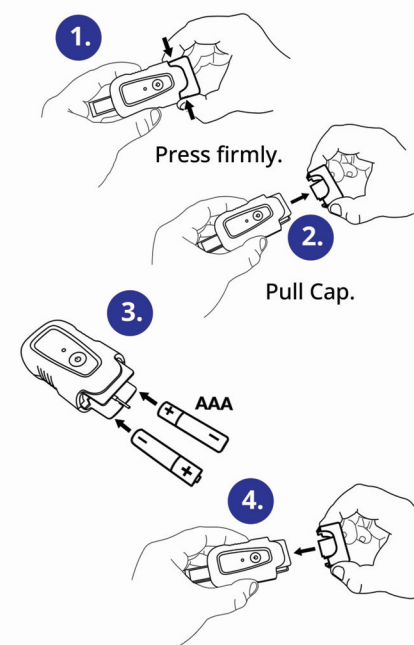

When the tool On/Off light flashes Red the batteries are low and need replacing.

Note - For optimal battery performance Bartec recommends 2x AAA 1.5v Alkaline batteries

#### Power On:

Press the power on/off button - the power light will show when on.

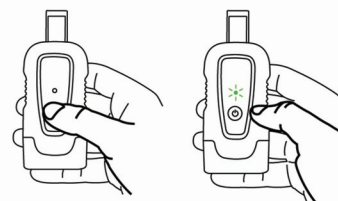

**Connectivity** The Tread-Rite® automatically connects to the TECH550PRO/TECH600PRO and no pairing is required.

## Connectivity

The Tread-Rite automatically connects to the TECH550PRO/TECH600PRO and no pairing is required.

## Completing a Vehicle Inspection: Bartec TPMS Tool

Using this feature allows for a complete vehicle inspection including OBD Diagnostics and Testing of TPMS Sensors, as part of a complete inspection report. Select New Service, Then choose Make, Model and Year (MMY). Select Tread Inspection.

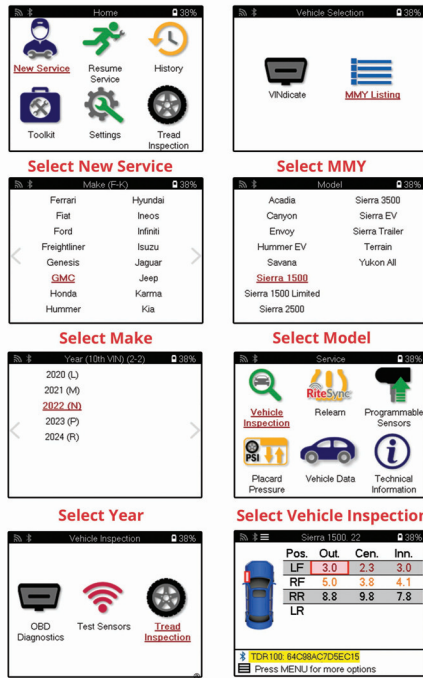

**Select Tread Inspection**

You will see that the Tread-Rite is connected to the Bartec TPMS tool (highlighted in yellow). Ensure the serial number listed matches Tread Rite being used.

## Completing a Tread Inspection: Bartec Tool

Using this feature allows for quick measurement of Tread Depth only. Start the process by selecting Tread Inspection on the main menu. Follow the tool instructions.

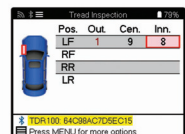

You will see that the Tread-Rite® is connected to the Bartec TPMS tool (pictured to left). Ensure the serial number listed matches Tread-Rite® being used.

Alternatively, use the Tread-RITE® App:



## Configurable Settings:

The user has the ability to select the Tread Depth Measurements. These can be configured as either 1 or 3 measurements per tire. Also, the unit of measurement can be displayed as mm or inch fractions.

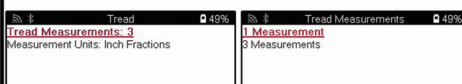

## Calibration:

This message will appear on the TPMS Tool when you first use the Tool, and when Calibration of the Tool is required.

Calibration is required to proceed with taking measurements. Press Enter to continue.

Place the TDR100 on a flat surface and fully depress the pin. Press and hold the Power button until the LED flashes.

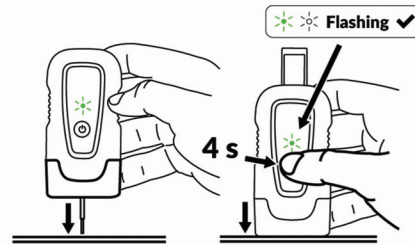

Put the Tool onto a flat surface, so that the tread pin is pushed in. Press and hold the power on/off for 4 seconds or until the green power light flashes.

## Correct Use of the Tread-Rite®:



Before completing a Tread Inspection, ensure the pin is pushed out by pressing the manual tread pin down. Ensure the end cap is flat on the tire tread.

**Note- Best practice is to measure tread is from the Outside, working inward.**

## Support and Troubleshooting:



**Note-** when calling Bartec ensure to have the Serial Number to hand.

**Note-** replacement parts are available through Bartec TPMS.



More information



Trouble shooting